

# EUROPA S

2026







## EUROPA S

The Europa S's clean, contemporary styling features modern hardwood cabinetry and is equipped with all the comforts, including a king size bed, a solid surface kitchen countertop, a comfortable trifold sleeper sofa (optional power theater seats shown) and a roomy dream dinette.

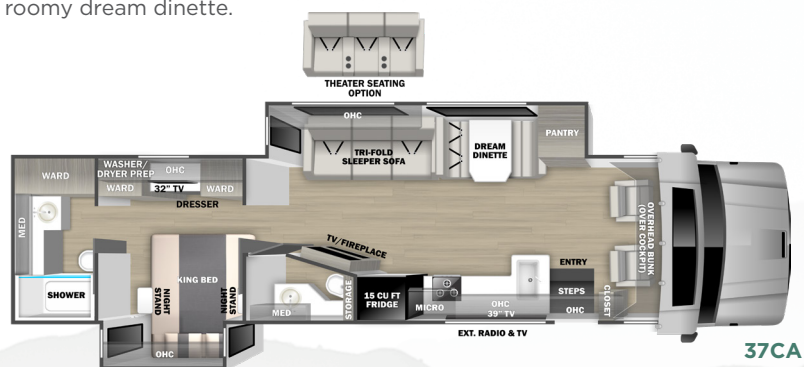

37CA

SPECIFICATIONS	37CA
GVWR (lbs.)	33,000
GCWR (lbs.)	45,000
GAWR - Front (lbs.)	12,000
GAWR - Rear (lbs.)	21,000
UVW* (lbs.)	26,658
Overall Length	39' 10"
Exterior Width	101"
Wheelbase	279"
Overall Exterior Height w/A/C	13' 2"
Interior Height	86"
Fuel Capacity (Gal.)	100
Water Capacities (Gal.) Fresh/Gray/Black	100/52/52
LPG Capacity (WC) (Gal.)	20.3
Awning Length	18'

\*UVW is an estimate only based on standard equipment.

## STANDARD FEATURES & OPTIONS

### CHASSIS

- Freightliner S2RV PLUS Chassis (33,000-lbs. GVWR / 45,000-lbs. GCWR)
- Cummins B 6.7L Turbo Diesel Engine (360hp / 800 lb-ft. of Torque)
- Allison 3000 MH Six-Speed Automatic Transmission
- 4.78 Rear Axle Ratio
- Trailer Hitch (12,000 Tow lbs. / 1,200 Tongue lbs.) with 7-Way Round Tow Connection
- 100-Gallon Fuel Capacity (Single Tank)
- 10-Gallon Diesel Exhaust Fluid Tank
- 240-Amp Alternator
- Air Brakes with 4-Wheel ABS
- Fuel Filter/Water Separator with Primer Pump
- Cummins VG Exhaust Brake System
- 21,000-lb. Rear Air Suspension
- Air Suspension Deflation System
- SACHS Front and Rear Shock Absorbers
- Rear Sway Bar
- Cruise Control
- Steel-Reinforced, Aluminum Cab
- Black Grille
- LED Headlights
- Daytime Running Lights
- Tinted Door Glass
- Front and Rear Tires: 295/80R22.5 (14 Ply Radials)
- Satin Black Aluminum Wheels (Set of Four)
- Single Front Wheels and Dual Rear Wheels (22.5" x 8.25")
- Bendix SmarTire Banded Tire Pressure Monitoring System
- Quick Disconnect Fitting with Tire Inflation Kit
- Engine Block Heater
- Leatherette Driver and Passenger Manual 6-Way Air Ride Cab Seats
- Side View and Back-Up Cameras
- Sony 10.1" HD Touch Screen Dash Infotainment System with AM/FM, Bluetooth, Sirius/XM (tuner and antenna), Wired and Wireless Apple CarPlay / Android Auto Connectivity, USB-C port, and High-Resolution Audio
- 12V Accessory Ports
- Chassis Battery Shut Off Switch in Cab
- Air Horn
- One Valve Parking Brake System with Warning Indicator
- Engine After-Treatment Device and Automatic Over-the-Road Regeneration
- Momentary Battery Booster Switch for Connecting Chassis and House Batteries
- Low Air Pressure Light and Buzzer
- Adjustable Steering Column
- 18" Leather-Wrapped Steering Wheel
- Power and Heated Exterior Mirrors
- Power Windows and Locks
- 3-Point Seat Belts

### CONSTRUCTION

- 2" Aluminum-Framed, Laminated Sidewalls with High-Density Block Foam Insulation
- Laminated Exterior Fiberglass
- Laminated 3" Aluminum-Framed Floor
- Fully Powder-Coated Steel Basement Construction
- Laminated Aluminum-Framed Radius Roof with High-Density Block Foam Insulation
- Crowned, One-Piece Laminated Fiberglass Roof

- Integrated Laminated Ductwork Throughout
- Fiberglass Rear Cap and Front Wing Panels
- Automatic, 4-Point Hydraulic Leveling Jacks
- Dual-Pane, Dark-Tinted Windows with Night Roller Shades
- Bonded Front Cap Window with Power Shade
- Carpeted Storage Compartments with LED Lighting
- Side-Hinged Aluminum Exterior Storage Doors with Paddle Latches

### EXTERIOR

- Custom Full Body Paint Package
- Premium Cut and Buffed Paint Finish
- Front-End Diamond Shield Paint Protection
- Armed Patio Awning with LED Lighting
- Slideout Toppers
- LED Patio Light
- Upgraded 30" Entry Door
- Acrylic Entry Grab Handle
- Power Entry Steps with Upgraded SeaDek Step Treads
- "One Key" Locking System for Exterior Storage Doors
- Exterior Wall-Mounted Entertainment Center with 32" LED Smart TV and Sound Bar
- Front and Rear LED Clearance and Marker Lighting
- Black Steel Cab Step Treads

### INTERIOR

- Front Cab-Over Bunk Area with Mattress (50" x 95") and Privacy Curtain
- Premium Vinyl Flooring Throughout
- Soft-Touch Padded Vinyl Ceiling
- LED Track and Recessed Puck Ceiling Lighting
- Sprung, Residential Style Dinette Seats with Lift Up Storage
- Shaker-Style Cabinetry
- Full Extension, Soft-Closing Drawer Guides (where applicable)
- Hidden Hinges
- 40" LED SMART TV (Living Area)
- Insignia Sound Bar
- Fireplace in Living Area (37CA)
- USB Charging Ports

### KITCHEN

- 15.5 cu. ft. Residential Refrigerator with Ice Maker
- Sealed Gas Range with Glass Cover
- Oven (First 13 Units Only)
- Microwave (First 13 Units Only)
- Convection Microwave Oven (Starting on 14th Unit)
- Solid Surface Countertops and Solid Surface Backsplash
- Gunmetal Steel Sink with Solid Surface Covers
- Gunmetal Gooseneck Faucet
- Pantry with Upper Soft-Close Pull-Out Drawers (37CA)
- Overhead Cabinet Accent Lighting
- Under-Cabinet Lighting
- MaxxAir Power Vent with Built-In Rain Cover

### BEDROOM

- King Bed (70" x 80") with Tilt-a-Bed Mechanism
- Designer Bedding Package
- 32" LED Smart TV
- LED Reading Lights
- USB Charging Ports

## BATHROOM

- Fiberglass Shower (48" x 30")
- Glass Shower Door
- Lighted Shower Skylight
- Deluxe Multi-Shower Head System
- Top-Mount Black Sinks with Residential Faucets
- Porcelain Electronic-Flush Macerator Toilet (37CA: Rear Full Bath)
- Porcelain Foot-Flush Toilet (37CA: Front 1/2 Bath)
- MaxxAir Power Vent with Built-In Rain Cover (37CA: Rear Full Bath)
- Mini Fan Power Vent with Built-In Rain Cover (37CA: Front 1/2 Bath)
- Shower Miser (Running Change - Starting on 14th Unit)

## UTILITIES

- Four (4) 6V AGM Deep-Cycle, Maintenance Free Batteries (450Ah Total)
- 200W Glass Solar Panel with 30-Amp Controller
- 2,000W Hybrid Pure Sine Wave Inverter/Charger
- 50-Amp Service with 34' Power Cord Reel
- PrecisionPlex Multiplex Wiring with Touch Screen Command Center and Bluetooth Smart Phone App Control
- 8kW Onan Diesel Generator with Auto Transfer Switch (Mounted on Isolator Pads)
- Automatic Generator Start
- Battery Disconnect
- Integrated Quiet Air Dual-Ducted, with Low-Profile 15,000-BTU Air Conditioners with Heat Pumps
- 40,000-BTU LP Furnace with Electronic Ignition
- 60,000-BTU GE Profile On-Demand Water Heater (LP)
- 20.3-Gallon LP Tank (WC)
- LP Quick Connect
- Water Filtration System
- Exterior Shower in Service Bay
- Exterior GFCI Receptacle
- Starlink Satellite Internet System
- Winegard OTA HDTV Antenna
- Cable TV / Satellite Hookup in Service Bay
- Gravity Sewer System
- Black Tank Flush
- Pressure Sense Tank Level Monitoring System
- 12V Heat Pads on Holding Tanks
- 12V On-Demand Water Pump (3 gallons per minute)
- Carbon-Monoxide, LP, and Smoke Detectors
- Fire Extinguisher

## OPTIONS

- Power Reclining Theater Seating with Heat and Massage
- Stackable Washer/Dryer

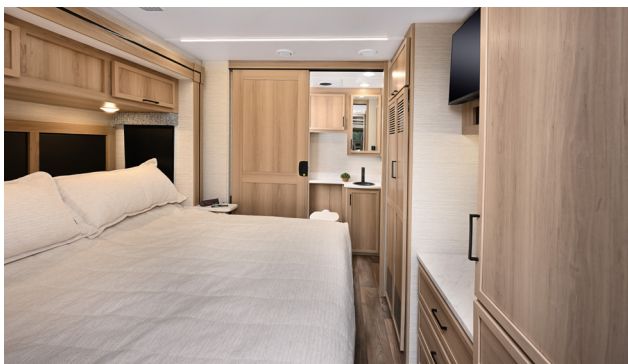

# DYNAMAX

2745 Northland Dr. • Elkhart IN 46514  
574-262-3474 • [www.dynamaxcorp.com](http://www.dynamaxcorp.com)

**GVWR (Gross Vehicle Weight Rating)** - is the maximum permissible weight of the unit when fully loaded. It includes all weights, inclusive of all fluids, occupants, cargo, optional equipment and accessories. For safety and product performance do NOT exceed the GVWR.

**GCWR (Gross Combined Weight Rating)** - is the maximum permissible loaded weight of your motor home and any towed trailer or towed vehicle. Actual GCWR of this vehicle may be limited by the sum of the GVWR and the installed hitch receiver maximum capacity rating; see hitch rating label for detail.

**GAWR (Gross Axle Weight Rating)** - is the maximum permissible weight, including cargo, fluids, optional equipment and accessories that can be safely supported by each axle.

**UVW (Unloaded Vehicle Weight)\*** - is the typical weight of the unit as manufactured at the factory. It includes all weight at the unit's axle(s), including full fuel, all fluids and LP Gas. The UVW does not include cargo, fresh potable water, additional optional equipment or dealer installed accessories.

\*Estimated Average based on stanxrdard build optional equipment.

**CCC (Cargo Carrying Capacity)\*\*** - is the amount of weight available for fresh potable water, cargo, passengers, additional optional equipment and accessories. CCC is equal to GVWR minus UVW. Available CCC should accommodate fresh potable water (8.3 lbs per gallon). Before filling the fresh water tank, empty the black and gray tanks to provide for more cargo capacity.

\*\*Estimated average based on standard build optional equipment.

Each Forest River RV is weighed at the manufacturing facility prior to shipping. A label identifying the unloaded vehicle weight of the actual unit and the cargo carrying capacity is applied to every Forest River RV prior to leaving our facilities.

The load capacity of your unit is designated by weight, not by volume, so you cannot necessarily use all available space when loading your unit.

Actual towing capacity is dependent upon your particular loading and towing circumstances, which includes the GVWR, GAWR and GCWR as well as adequate trailer brakes. Please refer to the Operator's Manual of your vehicle for further towing information.

All information contained in this brochure is believed to be accurate at the time of publication. However, during the model year, it may be necessary to make revisions and Forest River, Inc., reserves the right to make all such changes without notice, including prices, colors, materials, equipment and specifications as well as the addition of new models and the discontinuance of models shown in this brochure. Therefore, please consult with your Forest River dealer and confirm the existence of any materials, design or specifications that are material to your purchase decision.

©2025 Dynamax, a Division of Forest River, Inc., a Berkshire Hathaway company. All Rights Reserved. 11/25



Find us on  
**Facebook**

**FREE MEMBERSHIP**  
to Forest River Owners' Group

[www.forestriverfrog.com](http://www.forestriverfrog.com)



Dynamax Owner

"Digital Kit" App

Now you can have your Owner's Manual with you wherever you are. Download our FREE App from the App Store or Google Play and you'll have the information right at your fingertips.



Paint Video

<https://www.youtube.com/watch?v=sLgLoR26jfs>

Factory Video Tour

<https://www.youtube.com/watch?v=q5cG43PD7SE>



**Learn More:**

Scan this barcode using a QR reader on your smart phone to learn more about Forest River.



Your Authorized Europa S Dealer